

Thank you for choosing the Pro-Spec Easy Cruz for your ride. This Easy Cruz is designed for Bajaj Dominar. Once the Easy Cruz is engaged, it holds the accelerator in the desired throttle position. When the rider wishes to slow down, the accelerator can be brought back to its initial position by turning the accelerator in the direction of deceleration with the Easy Cruz being engaged.

Please follow the instruction carefully to ensure the desired benefit of the Easy Cruz.

1. Loosen the Allen head screw and remove the bar end from the Handle Bar.
2. Place the Easy Cruz and washer in place of the OE bar end as shown in the figure below.
3. Install the OEM screw and fasten it.

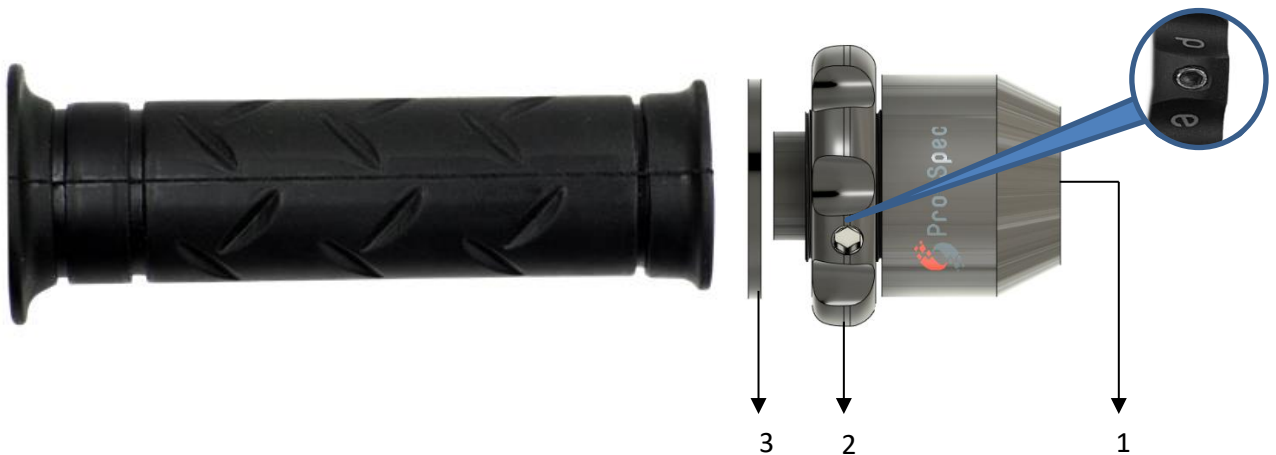

Sl.	DESCRIPTION	QTY.
1	Easy Cruz Body (PS ECZ 017)	1
2	Easy Cruz Knob (PS ECK 01)	1
3	Flat Step Washer (Ps Th-014-04)	1



The Easy Cruz is developed considering safe usability but it is the complete responsibility of the rider to be aware of the operation and purpose for which it is intended.



Please note that the grub screw shown in the picture should not be over tightened. Otherwise, it will lead to damage of the thread.

Note: Though the Easy Cruz retrofits are designed for DIY installation it is recommended you have them installed by a technician if you face difficulty.

I Square 3rd Floor, 293/295/229, Hennur Main Road,
 Post, opp. IOCL Petrol Pump, Kalyan Nagar,
 Bengaluru, Karnataka 560043

